

Bryan W. Shaw, Ph.D., P.E., *Chairman*  
Toby Baker, *Commissioner*  
Zak Covar, *Commissioner*  
Richard A. Hyde, P.E., *Executive Director*



## TEXAS COMMISSION ON ENVIRONMENTAL QUALITY

*Protecting Texas by Reducing and Preventing Pollution*

September 4, 2015

Mr. Scot W. Foltz, Environmental Compliance Manager  
Aqua Texas, Inc.  
1106 Clayton Lane, Suite 400W  
Austin TX 78723

Re: Municipal Setting Designation Certification (MSD) for City of Denton,  
Generally bounded by Interstate 35, Westway Street, North Carroll  
Boulevard, Dallas Drive, North Bell Avenue, East McKinney Street, and  
South Crawford Street, Denton, TX; MSD No. 282

Dear Mr. Foltz:

As required by TEX HEALTH & SAFETY CODE §361.807(a)(2), enclosed is a copy of the MSD dated September 4, 2015. The City of Denton passed an ordinance (Ordinance No. 2015-073) in support of this MSD application. For this reason, the Texas Commission on Environmental Quality is required to provide you a copy of the MSD Certificate.

If you have any questions, please contact me at (512) 239-2241.

Sincerely,

A handwritten signature in black ink that reads "Chris Swiderski" followed by a stylized flourish.

Chris Swiderski, Project Manager  
VCP-CA Section  
Remediation Division

CS/jdm

Enclosure: Copy of MSD Certificate No. 282

Bryan W. Shaw, Ph.D., P.E., *Chairman*  
Toby Baker, *Commissioner*  
Zak Covar, *Commissioner*  
Richard A. Hyde, P.E., *Executive Director*



## TEXAS COMMISSION ON ENVIRONMENTAL QUALITY

*Protecting Texas by Reducing and Preventing Pollution*

September 4, 2015

Mr. Joseph Mulroy  
Vacation Village Water/Wastewater Utilities System  
704 Lafayette Dr.  
Denton, Texas 76205

Re: Municipal Setting Designation Certification (MSD) for City of Denton,  
Generally bounded by Interstate 35, Westway Street, North Carroll  
Boulevard, Dallas Drive, North Bell Avenue, East McKinney Street, and  
South Crawford Street, Denton, TX; MSD No. 282

Dear Mr. Mulroy:

As required by TEX HEALTH & SAFETY CODE §361.807(a)(2), enclosed is a copy of the MSD dated September 4, 2015. The City of Denton passed an ordinance (Ordinance No. 2015-073) in support of this MSD application. For this reason, the Texas Commission on Environmental Quality is required to provide you a copy of the MSD Certificate.

If you have any questions, please contact me at (512) 239-2241.

Sincerely,

A handwritten signature in cursive script that reads "Chris Swiderski for".

Chris Swiderski, Project Manager  
VCP-CA Section  
Remediation Division

CS/jdm

Enclosure: Copy of MSD Certificate No. 282

Bryan W. Shaw, Ph.D., P.E., *Chairman*  
Toby Baker, *Commissioner*  
Zak Covar, *Commissioner*  
Richard A. Hyde, P.E., *Executive Director*



## TEXAS COMMISSION ON ENVIRONMENTAL QUALITY

*Protecting Texas by Reducing and Preventing Pollution*

September 4, 2015

Mr. Brendan Kennelly, President  
Oak Bend Homeowners Water Supply  
P.O. Box 802  
Denton Texas 76202

Re: Municipal Setting Designation Certification (MSD) for City of Denton,  
Generally bounded by Interstate 35, Westway Street, North Carroll  
Boulevard, Dallas Drive, North Bell Avenue, East McKinney Street, and  
South Crawford Street, Denton, TX; MSD No. 282

Dear Mr. Kennelly:

As required by TEX HEALTH & SAFETY CODE §361.807(a)(2), enclosed is a copy of the MSD dated September 4, 2015. The City of Denton passed an ordinance (Ordinance No. 2015-073) in support of this MSD application. For this reason, the Texas Commission on Environmental Quality is required to provide you a copy of the MSD Certificate.

If you have any questions, please contact me at (512) 239-2241.

Sincerely,

A handwritten signature in black ink that reads "Chris Swiderski for".

Chris Swiderski, Project Manager  
VCP-CA Section  
Remediation Division

CS/jdm

Enclosure: Copy of MSD Certificate No. 282

Bryan W. Shaw, Ph.D., P.E., *Chairman*  
Toby Baker, *Commissioner*  
Zak Covar, *Commissioner*  
Richard A. Hyde, P.E., *Executive Director*

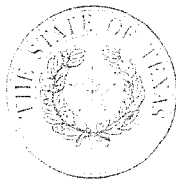

## TEXAS COMMISSION ON ENVIRONMENTAL QUALITY

*Protecting Texas by Reducing and Preventing Pollution*

September 4, 2015

Dr. Miki Taylor, Board President  
Forest Hill Number Two Water Supply Corporation  
5053 Golden Circle  
Denton, Texas 76208

Re: Municipal Setting Designation Certification (MSD) for City of Denton,  
Generally bounded by Interstate 35, Westway Street, North Carroll  
Boulevard, Dallas Drive, North Bell Avenue, East McKinney Street, and  
South Crawford Street, Denton, TX; MSD No. 282

Dear Dr. Taylor:

As required by TEX HEALTH & SAFETY CODE §361.807(a)(2), enclosed is a copy of the MSD dated September 4, 2015. The City of Denton passed an ordinance (Ordinance No. 2015-073) in support of this MSD application. For this reason, the Texas Commission on Environmental Quality is required to provide you a copy of the MSD Certificate.

If you have any questions, please contact me at (512) 239-2241.

Sincerely,

A handwritten signature in cursive script, appearing to read "Chris Swiderski for".

Chris Swiderski, Project Manager  
VCP-CA Section  
Remediation Division

CS/jdm

Enclosure: Copy of MSD Certificate No. 282

Bryan W. Shaw, Ph.D., P.E., *Chairman*  
Toby Baker, *Commissioner*  
Zak Covar, *Commissioner*  
Richard A. Hyde, P.E., *Executive Director*



## TEXAS COMMISSION ON ENVIRONMENTAL QUALITY

*Protecting Texas by Reducing and Preventing Pollution*

September 4, 2015

Ms. Sandra Barbey, President  
Lass Water Company Inc.  
P.O. Box 314  
Magnolia, Texas 77353

Re: Municipal Setting Designation Certification (MSD) for City of Denton,  
Generally bounded by Interstate 35, Westway Street, North Carroll  
Boulevard, Dallas Drive, North Bell Avenue, East McKinney Street, and  
South Crawford Street, Denton, TX; MSD No. 282

Dear Ms. Barbey:

As required by TEX HEALTH & SAFETY CODE §361.807(a)(2), enclosed is a copy of the MSD dated September 4, 2015. The City of Denton passed an ordinance (Ordinance No. 2015-073) in support of this MSD application. For this reason, the Texas Commission on Environmental Quality is required to provide you a copy of the MSD Certificate.

If you have any questions, please contact me at (512) 239-2241.

Sincerely,

A handwritten signature in black ink, appearing to read "Chris Swiderski".

Chris Swiderski, Project Manager  
VCP-CA Section  
Remediation Division

CS/jdm

Enclosure: Copy of MSD Certificate No. 282

Bryan W. Shaw, Ph.D., P.E., *Chairman*  
Toby Baker, *Commissioner*  
Zak Covar, *Commissioner*  
Richard A. Hyde, P.E., *Executive Director*



## TEXAS COMMISSION ON ENVIRONMENTAL QUALITY

*Protecting Texas by Reducing and Preventing Pollution*

September 4, 2015

Ms. Kimberly Pence, City Secretary  
Corinth  
3300 Corinth Pkwy.  
Corinth, Texas 76208

Re: Municipal Setting Designation Certification (MSD) for City of Denton,  
Generally bounded by Interstate 35, Westway Street, North Carroll  
Boulevard, Dallas Drive, North Bell Avenue, East McKinney Street, and  
South Crawford Street, Denton, TX; MSD No. 282

Dear Ms. Pence:

As required by TEX HEALTH & SAFETY CODE §361.807(a)(2), enclosed is a copy of the MSD dated September 4, 2015. The City of Denton passed an ordinance (Ordinance No. 2015-073) in support of this MSD application. For this reason, the Texas Commission on Environmental Quality is required to provide you a copy of the MSD Certificate.

If you have any questions, please contact me at (512) 239-2241.

Sincerely,

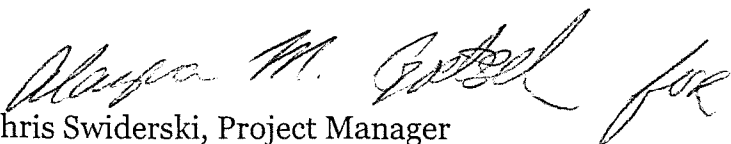
  
Chris Swiderski, Project Manager  
VCP-CA Section  
Remediation Division

CS/jdm

Enclosure: Copy of MSD Certificate No. 282

Bryan W. Shaw, Ph.D., P.E., *Chairman*  
Toby Baker, *Commissioner*  
Zak Covar, *Commissioner*  
Richard A. Hyde, P.E., *Executive Director*



## TEXAS COMMISSION ON ENVIRONMENTAL QUALITY

*Protecting Texas by Reducing and Preventing Pollution*

September 4, 2015

Mr. Donald Fryer, President  
Argyle Water Supply Corp.  
P.O. Box 249  
Argyle, Texas 76226

Re: Municipal Setting Designation Certification (MSD) for City of Denton,  
Generally bounded by Interstate 35, Westway Street, North Carroll  
Boulevard, Dallas Drive, North Bell Avenue, East McKinney Street, and  
South Crawford Street, Denton, TX; MSD No. 282

Dear Mr. Fryer:

As required by TEX HEALTH & SAFETY CODE §361.807(a)(2), enclosed is a copy of the MSD dated September 4, 2015. The City of Denton passed an ordinance (Ordinance No. 2015-073) in support of this MSD application. For this reason, the Texas Commission on Environmental Quality is required to provide you a copy of the MSD Certificate.

If you have any questions, please contact me at (512) 239-2241.

Sincerely,

A handwritten signature in cursive script that reads "Wayne M. Gotsch for".

Chris Swiderski, Project Manager  
VCP-CA Section  
Remediation Division

CS/jdm

Enclosure: Copy of MSD Certificate No. 282

Bryan W. Shaw, Ph.D., P.E., *Chairman*  
Toby Baker, *Commissioner*  
Zak Covar, *Commissioner*  
Richard A. Hyde, P.E., *Executive Director*



## TEXAS COMMISSION ON ENVIRONMENTAL QUALITY

*Protecting Texas by Reducing and Preventing Pollution*

September 4, 2015

Mr. Kenneth Banks  
Director of Environmental Services and Sustainability  
City of Denton  
215 E. McKinney St.  
Denton, Texas 76201

Re: Municipal Setting Designation (MSD) Certificate for City of Denton, Denton Downtown Corridor, Generally bounded by Interstate 35, Westway Street, North Carroll Boulevard, Dallas Drive, North Bell Avenue, East McKinney Street, and South Crawford Street, Denton, Denton County, TX; MSD No. 282; Customer No. CN600358980; Regulated Entity No. RN106590524

Dear Mr. Banks:

The Texas Commission on Environmental Quality (TCEQ) received the above referenced Municipal Setting Designation (MSD) application on May 4, 2015 and additional information supporting this MSD application on July 22, 2015. Based on our review, the application contains the required information as outlined in Texas Health and Safety Code (THSC) §361.804. Enclosed is the Municipal Setting Designation Certification for your site. If you have any questions, please do not hesitate to contact me at (512) 239-2241 or via e-mail ([chris.swiderski@tceq.texas.gov](mailto:chris.swiderski@tceq.texas.gov)).

Sincerely,

A handwritten signature in black ink, appearing to read "Chris Swiderski".

Chris Swiderski, Project Manager  
VCP-CA Section  
Remediation Division

CS/jdm

cc: Mr. Sam Barrett, Waste Section Manager, TCEQ Dallas/Ft. Worth Regional Office, R-4

Enclosure: MSD Certificate



TEXAS COMMISSION ON ENVIRONMENTAL QUALITY



MUNICIPAL SETTINGS DESIGNATION CERTIFICATE

As provided for in §361.807, Subchapter W, Texas Health and Safety Code (Solid Waste Disposal Act):

I, Beth Seaton, Director, Remediation Division, TCEQ, certify the Municipal Setting Designation (MSD) for MSD No. 282, in the City of Denton, for the tract of land described in Exhibit "A". The eligibility requirements of Texas Health and Safety Code §361.803 are satisfied as attested to by the affidavit in Exhibit "B", provided pursuant to Texas Health and Safety Code §361.804(b)(2)(D). This certificate shall continue in effect so long as the ordinance or restrictive covenant required by Texas Health and Safety Code §361.8065 remains in effect.

Any person addressing environmental impacts for a property located in the certified municipal setting designation shall complete any necessary investigation and response action requirements in accordance with Texas Health and Safety Code §361.808, in conjunction with the applicable Texas Commission on Environmental Quality environmental remediation regulation, as modified by Texas Health and Safety Code §361.808.

EXECUTED this the 4<sup>th</sup> day of September, 2015

Beth Seaton

Beth Seaton, Director  
Remediation Division  
Texas Commission on Environmental Quality

**EXHIBIT "A"**  
**LEGAL DESCRIPTION**  
**DENTON MUNICIPAL SETTING DESIGNATION AREA**

BEING 889.794 acres of land located in the R.H. HOPKIN SURVEY, ABSTRACT No. 1694, S. C. HIRAM SURVEY, ABSTRACT No. 616, A. HILL SURVEY, ABSTRACT No. 623, W. M. LOVING SURVEY, ABSTRACT No. 759, H. SISCO SURVEY, ABSTRACT No. 1184, W. M. NEILL SURVEY, ABSTRACT No. 971, B.B.B. & C. RR SURVEY, ABSTRACT No. 185, and R. BEAUMONT SURVEY, ABSTRACT No. 31, City of Denton, Denton County, Texas, incorporating all of or portions of the right-of-way areas of Dallas Drive, N. Carroll Boulevard, Teasley Lane, W. Parkway Street, Center Place Drive, E. Parkway Street, Meadow Street, W. Congress Street, Inman Street, Pauline Street, S. Locust Street, Marshall Street, N. Locust Street, N. Austin Street, E. Daugherty Street, Hann Street, Johnson Street, Withers Street, Smith Street, Ferguson Street, Fort Worth Drive, First Street, Myrtle Street, Second Street, W. Collins Street, Gary Street, S. Elm Street, Crescent Street, N. Elm Street, W. Third Street, W. Eagle Drive, Anna Street, Maple Street, W. College Street, S. Bell Avenue, Panhandle Street, N. Bell Avenue, Egan Street, Wainwright Street, E. Mulberry Street, W. Highland Street, S. Crawford Street, Pierce Street, W. Prairie Street, S. Bradshaw Street, E. Prairie Street, Piner Street, Stroud Street, Industrial Street, W. Sycamore Street, Frame Street, E. Sycamore Street, Highland Street, S. Exposition Street, Warren Court, W. Mulberry Street, Sombre Vista Drive, W. Hickory Street, E. Hickory Street, Alegre Vista Drive, W. Walnut Street, W. McKinney Street, Russell Street, Oakland Street, N. Austin Street, N. Cedar Street, W. Oak Street, E. Oak Street, N. Bradshaw Street, Railroad Avenue, Bolivar Street, W. Pecan Street, Oakland Street, E. McKinney Street, and all of or portions of the following additions and/or subdivisions with their respective recording data, Volume (V.) and Page (P.) or County Clerk's Document Number (DOC#) or Cabinet (C.) and Page or Slide (PG. or SL.): Access First Capital Addition, Alsup Addition, C. L, PG. 353, Alex Robertson Addition, C. A, PG. 180, Ashram Addition, V.12, P.24, Bacon Addition, C. B, PG. 69 and C. A, PG. 176, Baines Addition, C. Z, PG. 507, Baker Addition, C. W, PG. 65 and C. H, PG. 167, Barb Addition, C. W, PG. 457, Bell J. F. Addition, Victoria Station Addition, DOC# 2011-168, Bell Place Addition, Blount Addition C. A, PG. 147, C. B, PG. 282, C. T, PG. 273, C. Q, PG. 167, C. F. Martin Addition, C. G, PG. 10, Calvert Addition, C. F, PG. 257, Campus Housing Addition, C. R, PG. 198, Canton Addition, C. D, PG. 220, Car Wash Equipment Addition, C. E, PG. 374, and C. G, PG. 63, Carroll Addition (Denton), C. V., PG. 106, Carroll Park Place Two Addition, C. I, PG. 149, Carroll Park Place 2 Phase 2 Addition, C. Y, PG. 546, Carroll Point Addition, C. D, PG. 502 and C. Q, PG. 56, Centre Place Phase 1 Addition, C. T, PG. 384, Compass Bank Addition, C. X, PG. 620, Congress St. Addition, C. L, PG. 305, Crescent St. Addition, C. C, PG. 247, Cypress Campus at Denton Station Addition, DOC. # 2009-106 and V.2009, P.58, Dallas Drive Mini Storage Addition, C. D, PG. 327, Daugherty Addition, C. G, PG. 92, Davis-Smith Addition, De Hall Property Addition C. W, PG. 928, Denton Area Teachers Credit Union, Denton Park 35 Addition, C. U, PG. 418, Denton Rail Station Addition, DOC# 2011-54, Denton Station Phase One Addition, DOC# 2012-136, Denton Transit Center Addition, DOC# 2011-115, Don T. Rainey Addition, C. K, PG. 98, Down Town Addition, C. D, PG. 79, Doyle Addition, C. S, PG. 38, Eagle Point Shopping Center Addition, DOC# 2011-118, Eli Cox Addition, C. A, PG. 16, Faught Addition, C. M, PG. 21, Ferguson Addition, V.64, P.274, Floyd Re-plat Addition, C. J, PG. 300, Ford Properties Addition, C. E, PG. 242, Fred Hill Addition, C. K, PG. 361, Fred Moore Addition, C. U, PG. 733, Fulton & Spalding Addition, C. M, PG. 81, Garcia Addition, V.2009, P.168, Gossett Enterprises Addition, C. H, PG. 61, Grady McEuin Addition, C. K, PG. 88, Guy Laney Addition, C. U, PG. 899 and C. W, PG. 15, Hall-Lewis Addition, C. R, PG. 378, Hann Addition, Haywood-Jester Addition, C. D, PG. 245, Hickman Addition, C. D, PG. 106, Historical Park of Denton County Addition, C. X, PG. 448, Hwy 377-Racetrac Addition, C. V., PG. 112, Ilten

Addition, C. H, PG. 188, Inman Addition, Jack Bell Addition, Jack Brisco Addition, C. C, PG. 128, Jagoe & Preston Addition, C. C, PG. 57, Jasper Addition, C. W, PG. 604 and C. 2012, PG. 4, Jefferson Heritage, C. Q, PG. 211, Johnson Addition, C. E, PG. 184, Keas & Pruett Addition, C. E, PG. 1, King Addition, C. 2011, PG. 1, La Colina Ranch Addition, C. C, PG. 179, Lacy Addition, C. N, PG. 170, V.67, P.378 and C. B, PG. 57, Logan's Boot & Shoe Repair Addition, C. X, PG. 102, M & W Addition, C. E, PG. 119, Meadow Lake 3 Sec. 1 Addition, Marsh Addition, C. D, PG. 68, Myers Addition, Myrtle Addition, C. B, PG. 231, Nelson Addition, C. X, PG. 760, Northside Addition, C. A, PG. 129, C. C, PG. 191, C. B, PG. 375, C. F, PG. 17, C. G, PG. 324, C. J, PG. 147, C. E, PG. 104, C. G, PG. 50 and C. 2009, PG. 226, Northstar Bank Addition, C. W, PG. 102, O T Denton C. A, PG. 69, C. A, PG. 135 and C. F, PG. 381, Oak House Addition, DOC# 2014-40221, Offenbacker Addition, C. C, PG. 14, C. I, PG. 164, C. H, PG. 64 and C. H, PG. 36, Park Addition, Sunrise Center (Re-plat) Addition, C. B, PG. 108, Q T 905 Addition, C. U, PG. 770, Roy Riney Insurance Addition, C. U, PG. 655, Safeway Addition, C. J, PG. 179, Sanger Bros. Addition, C. E, PG. 166, Solomon Hill 1 Addition, C. I, PG. 178 & PG. 502, C. V, PG. 265, Solomon Hill 3 Addition, St. Andrew Presbyterian Church Addition, C. Q, PG. 226, Stroud Addition, Sunburst Place Two Addition, C. E, PG. 90 and C. E, PG. 245, Teasley Center Addition, C. E, PG. 370, Teasley Plaza Addition, C. H, PG. 117, C. H, PG. 93 and C. N, PG. 277, The Retreat at Denton, C. 2012, PG. 201, The Arts Council, C. E, PG. 314, Town Homes at Pecan Creek, C. X, PG. 876 and C. Y, PG. 573, TWT Addition, C. W, PG. 790, Victoria Square, C. Y, PG. 675, Village Office Park & Mini Storage, C. D, PG. 14, Wainwright's Addition, C. D, PG. 323, Watley Addition, C. D, PG. 321, Wood House Addition, C. H, PG. 298, Woodbridge Condominiums, C. A, PG. 171, Wooded Acres, C. A, PG. 165, C. J, PG. 98, C. E, PG. 368 and C. F, PG. 253, Woodhill Addition, C. C, PG. 322, Woodhill Square Addition, C. E, PG. 82, Sunrise Center Addition, C. B, PG. 108, **and all of the tracts of land** located in the **R. BEAMONT SURVEY, ABSTRACT No. 31**, conveyed to the following land owners with their respective recording data, Volume (V.) and Page (P.) or County Clerk's Document Number (DOC#): Fisher, Sarah L., DOC# 2013-80645; Spada, David & Bridget, DOC# 2005-158006; Hurd, Paul M. & Jessica A. & Sullivan, Paul J., DOC# 2014-65776; Radke, Don V., V.1878, P.545; Chang, Cheng Yeh, DOC# 2008-23163; Montoya, Jim & Marianne, DOC# 2012-4301; Leger, Susan Sortor, DOC# 2008-116241; Lane, Edward E., Jr., DOC# 2006-117453; Tomlinson, Timothy W. & Schumann, Brandy R., DOC# 03-191005; Miller, Jack E. & Morelle M., V.819, P.85; Murdock, Michael C. & Smith-Murdock, Rebecca L. Rev. Trust, DOC# 2010-15338; Ray, Dorothy, DOC# 2014-45708; Smith, Samuel D., DOC# 96-0029605; Cosimo, Vincent B. & Deborah, DOC# 95-0040878; Fritts, Jackie F. & Darlene Munger-Gersch, DOC# 93-0027024; Fickey, Suzanne R., DOC# 95-0071769; Jones, Rachel L., DOC# 93-0071965; Warzwick, Fred T., DOC# 2009-128216; Warzwick, Fred T. & Elizabeth A., V.1772, P.694; Schnurbusch, Joanne, DOC# 2013-88360; Johnson, Marion S., V.576, P.311; Musick, Cheryl Lynn, DOC# 03-133248; Sittell, Nancy Roberta, DOC# 02-67923; Toews, Kathleen & Ivan & Clara, V.3107, P.289; Aggie Interests LLC, DOC# 2014-48063; DeJesus, Margarito & Maria, DOC# 97-0057104; Martinez, Gail R., DOC# 01-134065; Reeves, Theresa L., DOC# 2009-129650; Reeves, Theresa L. & Alvin S., DOC# 2012-71514; Dotson Properties LLC, DOC# 2014-25592; 6-D Family LP, DOC# 04-125025; Taylor, Howard D. & Shirley, DOC# 99-0058796; Cole Irwin Inv. LTD, DOC# 98-0001778; Cumberland Presbyterian Childrens Homes, DOC# 2013-366; Shea, J. Daniel Living Trust, DOC# 2013-366; Russell, Benny R. & Barbara, V.825, P.638; Hall, Linda T. & Edward M., DOC# 2012-144079; Hammett, Laurie Jones, V.913, P.53; Schnurbusch, Joanne, DOC# 2013-88359; Hanson, Candis Wood, DOC# 2014-6420; Stachelski, Patricia L., DOC# 97-0068016; Nicholson, Tamara, DOC# 2009-141999; Slater Dev. Inc., DOC# 2008-73061; Byrom, Henry A., V.415, P.134; Warzwick, Fred T., DOC# 2010-35726; Bickley, Josh P., DOC# 2006-122438; Orr, Kathy F. & Fickey, Suzanne, DOC# 97-0090781; Infini Inc., DOC# 2012-132944; Belcher, Bobby & Barbara, DOC# 2011-109390; Denton, City Of; Goldsmith, Alan, DOC# 2012-135405; Land, Ronnie & Lynell, DOC# 93-

0029521; Cope, Billy W. & Seaborn, Susan, DOC# 2013-79823; Surratt, Marshall, DOC# 2011-22934; Beck, Charity R. & Gregory P., DOC# 00-54236; Hall, Matthew E., DOC# 2008-54979; Coleman, Victoria R., DOC# 2014-43759; Miller, Morelle M., DOC# 2007-108009; Adami, John S., V.1644, P.945; Hoeffler, John V. & Fritts, Robert, DOC# 97-0024140; McCormack, Kelly & Cecelia, DOC# 03-93639; Cosimo, Vincent B. & Deborah, V.3405, P.879; Gibson, Edred A. & Nancy L., DOC# 04-63698; Webb, Scott E. & Jeanne E., DOC# 2006-17878; Dobbs, Doy & Dee and Luster, Paul & Reila, DOC# 05-122058; Luster, Paul, DOC# 99-0103628; Luster, Paul, DOC# 05-108045; Perez, Lisandro & Joann C., DOC# 05-43109; Hall, Linda T. & Edward M.; Sinor, Bryan Floyd, DOC# 04-88584; Lavezo, Stephen, V.1148, P.954; Wenrich, Lindsey Beth, Per Marriage-License; Lowerie, Kenneth D. & Billie R., DOC# 02-39623; Taylor, Sandra L., V.849, P.714; **all of the tracts of land** located in the **B.B.B. & C. RR SURVEY, ABSTRACT No. 185** conveyed to the following land owners with their respective recording data, Volume (V.) and Page (P.) or County Clerk's Document Number (DOC#): Denton, City Of; USA Corp Of Engineers, V.597, P.102; Graves, John & Donna, DOC# 2007-39153; McConnell, Lynelle C. Ind. Executor Griffin, Doyle Estate, DOC# IE-2000-493; Ragsdale Properties LTD, DOC# 94-0095215; Aebersold, Nancy & Blumrosen, Dana R., DOC# 06-5443; Wilson, Carol Jane Trustee Of Carol Jane Wilson Revocable Trust, DOC# 2012-2715; Shelton, Kerri A., DOC# 2011-MARR LIC; Panhandle Street Properties LTD, DOC# 2009-36674; McGehee, Larry D. & Kimberly, DOC# 95-0060331; Keen Quest Enterprises LLC, DOC# 2014-2023; Luxie LLC, DOC# 2009-39369; Luster, Gene A., DOC# 94-0072671; Thorngren, John T., DOC# 2011-77057; Floyd Family Properties LTD, DOC# 2009-36659; Land, Lawrence R. & Taliaferro, Sam, DOC# 94-0070281; Kelsoe Riley Jv, DOC# 04-96497; Conner, William James Allen III, DOC# 2014-52067; Fitzgerald, Sean P. & Mary Beth, DOC# 05-83213; Ginnings, Rebecca Jean, V.489, P.33; McElhinney, Antoinette, DOC# 2010-41968; Major, Jason L. & Ginger L., DOC# 2014-85308; Wan, William W., V.1095, P.262; Saratan Corporation II, DOC# 2010-54390; Simmons, Kirk, DOC# 04-12553; Harris, Roy E. & Joyce V., V.1049, P.421; Saratan Corporation I, DOC# 2011-20154; Ashram, Kundalini Yoga, DOC# 06-7620; Ashram, Kundalini Yoga, DOC# 2007-16799; Jack Schmitz & Son Funeral Home, V.2857, P.369; Beck, Winfred C., Jr., DOC# 02-45857; Beck, Winfred C., Jr., DOC# 02-478130; Denton Tristar Investments LLC, DOC# 2009-78482; Jack Schmitz & Son Funeral Home, DOC# 2012-146289; Denton Tristar Investments LLC, DOC# 2009-87482; Denton Tristar Investments LLC, DOC# 2009-78477; Crouch, Bob A., V.582, P.333; Lane, Eddie, DOC# 2006-132140; Simone Urschell LLC, DOC# 2012-51497; Denton Tristar Investments LLC, DOC# 2009-78478; J. Hawley Properties LLC, DOC# 2014-52510; Herod Holdings, LLC, DOC# 2007-126590; 815 Elm Office Realty, LTD, DOC# 2012-129917; Chew, Marcus R., DOC# 2010-3833; Ruch, Milo & Denise C., DOC# 2007-118779; Wong, Keith K. Ching, V.994, P.160; Wixsom, Emma Trust, DOC# 00-58605; Owen, Treaver & Rhonda, DOC# 97-0037656; Darby, Bob R. & Penny L., DOC# 94-0057916; St. Paul Lutheran Church, DOC# 04-136238; Owen, Rhonda, DOC# 96-0023875; St. Paul Lutheran Church, DOC# 2007-11754; St. Paul Lutheran Church, DOC# 04-136238; Lutheran Church, V.230, P.291; St. Paul Lutheran Church, V.509, P.222; Ricks, Murray N. & Diane K., DOC# 2013-31896; St. Paul Lutheran Church, V.1649, P.194; Lutheran Church, V.376, P.110; St. Paul Lutheran Church, V.1718, P.905; Phillips, Joan Marie, DOC# 2009-72318; WOFG Inc., DOC# 99-0117700; Davis, R. Glenn, DOC# 2008-29665; Dunkey Partners LTD, DOC# 05-109097; Bailey Family Partners II, LTD, DOC# 2012-147784; HEA Management Group Inc., DOC# 96-0075940; Williams, Loran Kay, V.2436, P.85; Cervantes, Juan C. & Yadhira Santos, DOC# 2009-48651; Cervantes, Juan C., DOC# 98-0047419; Denton, City Of, V.761, P.553; Denton, City Of, V.183, P.331; Russell, Benny R. & Barbara A., DOC# 99-0031321; Reese, Mary Noel, DOC# 94-0017650; Stippe, Stephen, DOC# 97-0059511; Denton Bible Church, DOC# 2012-58201; Holley, Katie, DOC# 02-164812; Prier, Lisa C., DOC# 2013-24669; Rizo's Salon, DOC# 00-07794; Myrik Properties Inc., DOC# 2009-137934; Reid Family Rev Living Trust, Reid, Darrell G. Trustee, DOC# 01-112290; Leaving A Christian Legacy LLC, DOC# 2012-106404;

Slater Dev Inc., DOC# AH-00-50418 5/31/00-00-50420; Foster, Leddy, DOC# 2012-63401; J. Hawley Properties LLC, DOC# 2014-52510; Brownell, Guiseppe & Robin, DOC# 2012-45835; Giuseppe Italian Restaurant, DOC# 2011-1604; **all of the tracts of land located in the S.C. HIRAM SURVEY, ABSTRACT No. 616** conveyed to the following land owners with their respective recording data, Volume (V.) and Page (P.) or County Clerk's Document Number (DOC#): Keystone Management, LLC, DOC# 2008-108963; McCleskey, Michael, V.818, P.666; White, Donald R., Sr. & Sandra L., DOC# 02-21438; White, Donald R., DOC# 01-65709; Boydston, F. R., V.532, P.622, & V.532, P.625, & V.628, P.704; **all of the tracts of land located in the A. HILL SURVEY, ABSTRACT No. 623** conveyed to the following land owners with their respective recording data, Volume (V.) and Page (P.) or County Clerk's Document Number (DOC#) or Cabinet (C.) and Page or Slide (PG. or SL.): Beaty, Tim, DOC# 98-0071859; Harrison, Phillip L. & Mitzi, DOC# 05-93822, 93826; Amini, Setoudeh Hafiz, DOC# 2014-82114; Treece, Larry J., DOC# 04-130626; TXAfford LLC, DOC# 2009-10949; McDonald, Alfred John, DOC# 2012-20788; O & C Freeman Family LTD, DOC# 96-0048250; Riley Property Investments LLC, DOC# 2013-123422; Calvert, John A. & Elizabeth D. & Moses, Mary, DOC# 96-0013617; Calvert, John A. & Elizabeth D. & Moses, Mary, DOC# 96-0013616; Holiness Mission Church, V.394, P.577; Calvert, J. Wayne, DOC# 84-49311; C C Ballard Holdings LLC, DOC# 2013-124391; Allen, Wayne O., DOC# 02-111356; Allen, Wayne O., DOC# 02-146101; Jetpuri Family LP, DOC# 2009-109863; Jacinto, Juan & Marina, DOC# 2006-43332; Orozco Properties, LLC, DOC# 2009-114094; Riley, J. Mike, DOC# 2012-96654; Mesta, Baltazar, DOC# 01-12296; Denton ISD, DOC# 2011-104352; Pecan Grove Office Park, LLC, DOC# 2013-85183; Pecan Grove Office Park, LLC, DOC# 2013-85882; Riley, J. Mike, DOC# 2013-17656; Riley Property Investments LLC, DOC# 2013-123422; Thorp, Tatyana, DOC# 2012-103199; Mach, Eric J., DOC# 05-154126; Tjandramulia, Berdy, DOC# 01-136198; Ayala, Maria I. & Rosa E., DOC# 93-0055472; Codela LLC, DOC# 2012-145972; Anvari, Behrooz & Ebrahimi, Massoud, DOC# 00-54523; Ruiz, Garcia Miguel A., DOC# 98-0072631; Blackburn, Billy Gene, V.544, P.143; Chamberlain, Alan Ray & Linda Adele Duffy Tr. Of The Chamberlain Tr., DOC# 05-16559; Jeter, Patricia L. & Hilliard, Martha & Lee, Donald R. Etal, DOC# 2009-118557; North Texas Mini Storage, LLC, DOC# 2010-87771; LTL Properties LLC, DOC# 2013-91571; Selby, Richard M. & Susan M. Buehner, DOC# 2011-110116; Denton, City Of, V.680, P.277; Denton, City Of, DOC# 97-0020884; Smith, Mildred B.; Woods, Richard, DOC# 94-0042494; Foster, Gary Lee, DOC# 94-0056132; Gonzalez, Emilio L. & Guadalupe, V.563, P.475; Fisher, Paul S., DOC# 01-31554; Stoffer, Micheal Lee, DOC# 2014-55070; Oram, Richard Ian, DOC# 2012-29446; Caldwell, Bobbie Jean Phillips, Aff'd of Heirship; Miller, Morelle M., V.1295, P.0088; McGregor, Joel N. & Sandra Dean Trs. McGregor Family Trust, DOC# 2013-38348; McGregor, Joel N. & Sandra Dean Trs. McGregor Family Trust, DOC# 2013-38349; Black, Steven & Betty, DOC# 03-84940; Smith, Wilda J., V.424, P.420; STP Properties, Series LLC; Atlas Drive Series, DOC# 2014-21466; Miller, Darlene Alice, DOC# 2013-68487; Brown, David E., DOC# 96-0041555; Brown, David E., V.1163, P.436; Gonzalez, Emilio L. & Guadalupe, V.885, P.51; Brown, David E., DOC# 96-0041554; Black, Steven & Betty, DOC# 04-29147; Collora, Peter, DOC# 02-1463; Barta, Thomas J. & Kathleen J., DOC# 2009-1948; Krahl, Shane, DOC# 2009-55208; Austin, Kermit W., DOC# 2006-147891; Biggs, C. W., DOC# 93-0071182; Redus, Hubert B., DOC# 99-0055283; Banister, Vernon M., DOC# 94-0036750; Davenport, Beverly Ann, DOC# 2007-63918; GMSS Inc., DOC# 00-43277; Gonzalez, Emilio L. & Guadalupe, V.616, P.440; Mason, Robert W., DOC# 1553 -623; Calvert, John Alan, DOC# 06-5457,8; Carmona, Valentin, DOC# 00-43345; Jackson, David, DOC# 2010-88167; Quevedo, Irma Lucrecia & Quinonez, Ezequiel A., DOC# 2012-43071; Russell, Benny R. & Barbara A., DOC# 97-0084794; Lassiter, Clarice, V.2280, P.771; Pursur, Roy H. Or David E., V.2098, P.616; Reding, Mark, DOC# 2010-126108; Baker, Timothy Lee, DOC# 2011-64495; Bryant, Buford James, V.754, P.732; ZB Eagle Partners LTD P/S, DOC# 93-0036887; H & S Leasing Inc, DOC# 2013-111065; Johnson, Ronald C. & Shirley, DOC# 2009-88839; Baker, Pat &

Timothy Lee, DOC# 2014-72641; Bean Housing LLC, DOC# 2014-92374; Spencer, Patricia E., DOC# 142-12-157772; Ludlow, Robert A., DOC# 94-0092786; Barrow, James H., DOC# 98-00100725; I-35 Denton Station LTD, DOC# 2008-19742; Brown, Kenneth S., DOC# 01-5139; Rahimi, Mohammad B. & Cynthia D., DOC# 03-168471; Mitchell, Wayne L., V.1977, P.121; Kerr, Karen D., V.2317, P.1; Jeter, Jarrod Mack, DOC# 98-0025115; Parks, Will, V.194, P.525; Denton, City Of, V.567, P.17; Denton, City Of, V.565, P.672; Denton, City Of, V.581, P.34; Denton, City Of, V.576, P.225; Denton, City Of, V.598, P.170; Denton, City Of, V.587, P.616; Denton, City Of, V.419, P.251; McNairy, Robert R., DOC# 01-21839; Purvis Industries, LTD, DOC# 2008-99045; Jean Roberts Family Partners LTD, DOC# 00-09586; Sprabary, Jimmy & Susan, DOC# 2008-3561; Chavez, Cesar Rubio, DOC# 2006-90758; McNairy, Robert R., DOC# 2013-49012; Garcia, Lorrie A., DOC# 2006-33394; Orozco, Octavio, DOC# 2013-49517; Ilten, David E., DOC# 96-0055528; North Texas Mini Storage, LLC, DOC# 2010-87772; Alambar, Erasmo, DOC# P.R-2014-00126; Tabares, Jesus U. & Dora E., DOC# 03-133012; Alquicira, Jose Elias & Maria Del Carmen Gallardo, DOC# 2014-97848; Calvert, John A. & Elizabeth, DOC# 96-0013619; all of **the tracts of land** located in the **W. M. LOVING SURVEY, ABSTRACT No. 759** conveyed to the following land owners with their respective recording data, Volume (V.) and Page (P.) or County Clerk's Document Number (DOC#): Limpede, Richard, DOC# 2013-115567; CCI Inv. LTD, DOC# 00-58859; CCI Inv. LTD, DOC# 2009-140580; Irwin, Dale & Charlotte M., DOC# 95-0035059; Jester, Tom D., Jr., DOC# 02-52659; F & S Inv. LP P/S, DOC# 97-0003029; Barndominium Investments LLC, DOC# 2013-59817; Smitherman, Darren L., DOC# 2009-31811; Voiers, Marvin, V.2920, P.507; Collins, Wayne Clark Sr. & Lee Hawkins Fish Living Trust, DOC# 2013-42804; Wright Management LLC, DOC# 2008-90920; Shelton, Jerry W. & Carol M., DOC# 04-2810; Brooks, Tommy, DOC# 02-29426; Dotson Properties LLC, DOC# 2014-25592; Russell, Benny R. & Barbara, DOC# 2009-62106; Moseley, George W., Jr., V.1220, P.847; Elder, Stephen L., V.816, P.804; Saratan Corporation II, DOC# 2012-144670; Garcia, Moises & Vladimir M., DOC# 2006-100120; Campbell, John & Kathleen, V.2990, P.3.7; Denton Masonic Museum & Library, Inc., DOC# 2007-137115; Sires, Justin, DOC# 2009-120078; Kim, Liudmyla, DOC# 2010-71911; Warzwick, Fred T., V.2045, P.773; King, Arthur V. & Rebecca, DOC# 2013-142842; Parsons, Audie & Jewel, DOC# 00-95247; Llami, Paul & G. Frank Garrison, DOC# 04-92300; Sorrells, Randy & Nancy, DOC# 2010-102512; Dawson-Rieger, Joan N., DOC# 2013-3822; Manning, Donald C., DOC# 2011-107467; Kimmey, Jimmie E., V.3261, P.248; Perrin, Douglas W., DOC# 99-0079240; Jeter, John H., V.463, P.597; H-3 Residential, LTD, DOC# 2012-140015; Kirby, Marge, DOC# 2012-76866; Floyd, Gay & David, DOC# 2012-140015; Woolaver, Calvin, DOC# 95-0050586; Courtney, Johnny Burl, DOC# 2007-48312; Bailey, Patricia J., V.96, P.454; Portales, Alfredo, V.2225, P.128; Miller, Jack E. & Morelle, DOC# 95-65716; McGehee, Larry D. & Kimberly, DOC# 93-0050302; Miller, Jack E. & Morelle M., V.1214, P.94; Marsh, Lenora Kay, DOC# 2008-48988; Lane, Edward E., Jr., DOC# 2009-128004; Rowe, William S., DOC# 2009-80561; Massey, Carol, DOC# 2013-151432; O & C Freeman Family LTD, DOC# 96-0048247; Denton, City Of, V.766, P.783; Kelsoe Construction & Development Inc., DOC# 2013-59796; McGehee, Larry D. & Kimberly, V.3366, P.299; Kelsoe Construction & Development Inc., DOC# 2008-137848; Yuhas, Andrew T. & Julie P., DOC# 2012-107160; Acker, David F., V.1119, P.508; CCI Inv. LTD, DOC# 04-85258; Mathiasch, Annie B. LF Est Etal, DOC# 2003-150943; Kelsoe Construction & Development Inc., DOC# 2009-4568; McGehee, Larry D., V.2626, P.11; 518 Acme LTD, DOC# 2008-52615; Marsam Enterprises Inc., DOC# 2013-72384; San Miguel, Francisco & Amabilia, V.3097, P.485; ZB Eagle Partners LTD P/S, DOC# 95-0004078; Yount, Gary, DOC# 2013-92108; Sorrells, Randy, DOC# 2012-141980; Wormy Dog LLC, DOC# 2014-16244; Clark, Roderick, DOC# 2012-143627; Nguyen, Hanh My, DOC# 2012-50437; Seven Operating LLC, DOC# 2014-17743; Frontier Waterproofing Inc., DOC# 05-34564; Denton, City Of, DOC# 2010-71488; Marrs Holdings LLC, DOC# 2011-74349; Terrell Painting & Wallcovering Inc., DOC# 2011-90543; Howe, Leroy M., DOC# 99-0065304; Eagle Salon Suites

LLC, DOC# 2014-72480; Fowler, Gregory C. & Awtrey, Luann, DOC# 2007-107220; Denton, City Of, DOC# 00-64706; Terrell, Tamera Lynn, DOC# 2006-142593; Smitherman, Darren & Lindsey, DOC# 2011-70821; Eusepi, Carly A. & Jackson, Zachary J., DOC# 2007-50878; DATCU, DOC# 98-0105755; Helland, Eric L. & Pamela K., DOC# 2007-59362; McGehee, Larry D. & Kimberly, V.3072, P.417; Thongcome, Somkid, DOC# 2008-134650; Berlanga, Sergio A. & Erika A., DOC# 2009-128008; Winnette, Julie, DOC# 2011-71127; Denton Buildings LP, DOC# 2007-142991; JCJ Rentals LLC Etal, DOC# 2012-79307; Shumake, Rueben, DOC# 2014-99929, all of the tracts of land located in the **W. M. NEILL SURVEY, ABSTRACT No. 971** conveyed to the following land owners with their respective recording data, Volume (V.) and Page (P.) or County Clerk's Document Number (DOC#): Moon, Christina L., DOC# 99-0087870; Lambert, Margaret J., Death Certificate; Jeffries, Marvin & Gudron Tr Of Revocable Living Tr, DOC# 03-122406; JDFIU Radio LLC, DOC# 2011-16733; RLB Investments LLC, DOC# 2007-131952; Cross Timbers Community Church , DOC# 2007-131952; Northstar Bank Of Texas, DOC# 2007-83424; Northstar Bank Of Texas, DOC# 00-00015303; Burkett, Adam C., DOC# 04-5898; Denton, City Of, V.572, P.262; 4th Frame LLC, DOC# 2012-136025; Raesz, Chris, DOC# 01-121195; Caralinda Partners III L., DOC# 97-0090083; St. Andrews Presbyterian Church, DOC# 04-97677; St. Andrews Presbyterian Church, DOC# 00-59232; 220 West Oak Partners LLC, DOC# 2014-79981; Brown, Scott, DOC# 97-0047097; Denton, City Of, DOC# 77003368; Denton, City Of, V.261, P.407; Burt, Sun Tok, V.2173, P.494, P.502; Ennis, Billy M. & Anna, DOC# 97-51215; Ennis, Bill M., DOC# 99-0044875; Ennis, Billy M. & Anna, DOC# 96-0045250; Venables, Barney James & Cynthia C. Tr Of Venables Rev Trust, DOC# 2011-86760; OMLCP LP, DOC# 2009-60155; General Telephone Co., V.579, P.561; First Security Bank, NA, DOC# 2011-120571; Darby Real Estate Partnership, DOC# 2008-109603; Famin Corporation, DOC# 2006-59275; Bancroft, Christopher, V.2032, P.58; Arab, Al Karim P. & Rozina A., DOC# 98-0071394; DIYAA Adventures LLC, DOC# 2009-144514; Hammett, Gary W., V.2155, P.173; Greater Denton Arts Council, V.2889, P.774; all of the tracts of land located in the **H. CISCO SURVEY, ABSTRACT No. 1184** conveyed to the following land owners with their respective recording data, Volume (V.) and Page (P.) or County Clerk's Document Number (DOC#): Stockard, G. E.; Storrie, Robert C., Jr., Trustee, V.361, P.485; Storrie, Robert C., Jr., Trustee, V.420, P.191; Storrie, Robert C., Jr., V.613, P.6; Storrie, Robert C., Jr., Trustee, DOC# 84-27745, & V.694, P.511; Storrie, Robert C., Jr.; Ramarson Partners LLC, DOC# 2009-100378; Andaman Group LLC, DOC# 2014-2326; Denton Elks Lodge, V.2137, P.677; Vibe Investment Partners LLC, DOC# 2009-81473; Luxie LLC, DOC# 2011-25618; Storrie, Robert C., Jr.; Frontier Waterproofing Inc., DOC# 2008-122764; Denton Publishing Co., V.1482, P.205; Chident Holdings LLC, DOC# 2014-5991; Burgoon, Weldon & Joy, V.3167, P.243, P.247; Burgoon, Weldon, V.497, P.37; Warehouse Of Denton LP, DOC# 2006-6134; Dallas Area Rapid Transit, DOC# 2010-43179; Redi Mix Inc., DOC# 95-0036084; Redi Mix Inc., DOC# 93-0048556; Locklin, George, Jr.; Locklin, George, Jr., V.975, P.282; Woodson, D. C. & Arvella, V.479, P.415; Denton, City Of; Kamy Real Property Trust, DOC# 2014-44830; Denton, City Of, DOC# 2008-1968; Purvis Industries LTD, DOC# 2014-26942; Bread Building LLC, DOC# 2009-86196; Lone Star Gas Co., V.626, P.398; Loveless, W. M., V.412, P.196; Collision Works Of North Texas LLC, DOC# 05-120322; Starnes Rentals LLC, DOC# 05-42445; KB Properties, DOC# 98-0052976; Starnes Rentals LLC, DOC# 05-42444; Denton, City Of, DOC# 00-0027238; Denton, City Of, DOC# 00-119948; Romskog, Kevin, DOC# 2008-116767; Admire, Inc., DOC# 2006-63793; Denton, City Of, DOC# 01-6779; Estrada, Sergio R. & Ramirez, Concepcion H., DOC# 05-56922; Gohlke, Gene A., V.1776, P.0084; JWKW Real Estate Inc., DOC# 2009-69655; Denton, City Of, V.2902, P.950; Dealers Electrical Supply Corp., V.1116, P.963; DSM Partners I LTD, DOC# 2014-49312; East Hickory VI LLC, DOC# 2009-122728; Transit Center Inv. LC Etal, DOC# 2011-124992; Pensco Trust Co & Transit Center Investments LC, DOC# 2010-43945; Arrington, Virgle L., Acct Combined; Denton, County Of, DOC# 2013-1264; Dave & Dave LTD CO., DOC# 97-0050767; Prout, Edward C., DOC# 2014-2872; Prout,

Saturn B., DOC# 2014-2871; Second Hand Sports & Game Swap LLC, DOC# 2012-64185; Baish, Joshua A., DOC# 99-0106741; Trinity Mining & Construction Equipment Inc., DOC# 2013-43705; Green, D. Edward, DOC# 02-118031; Green, D. Edward, DOC# 02-118033; Baker Family Partners LTD, DOC# 96-0020890; Baker Family Partners LTD, DOC# 96-0030890; Jodo Co, LLC, DOC# 2014-19461; Trinity Utility Structures LLC, DOC# 2013-43705; Cohagen, Joan Trustee, Cohagen Living Trust, DOC# 02-55821.

Said 889.794 acres of land being more particularly described by metes and bounds as follows:

BEGINNING at a point at the intersection of the Southwest right-of-way line of Dallas Drive (a variable width public right-of-way) and the North right-of-way line of Interstate Highway No. 35 E. (a variable width public right-of-way), and said POINT OF BEGINNING, being the East corner of the 0.905 acre tract of land conveyed to D.V.B. Family L.P., by the deed recorded in Volume 5144, Page 2472, of the Deed Records of Denton County, Texas;

THENCE along the North right-of-way line of said Interstate Highway No. 35 E., as follows:

1. S 49° 32' 41" W 155.46 feet, to a point;
2. NORTHWESTERLY 204.75' feet, along said curve to the right, having a radius of 2989.00' feet, a central angle of 3°55'29", and a chord bearing of N 79° 41' 14" W 204.71' feet, to a point at the end of said curve;
3. N 79° 41' 14" W 3.00 feet, to a point;
4. N 73° 47' 24" W 404.09 feet, to a point;
5. N 82° 47' 44" W 881.93 feet, to a point;
6. N 76° 07' 49" W 312.69 feet, to a point;
7. N 70° 09' 16" W 200.59 feet, to a point;
8. N 58° 24' 06" W 219.06 feet, to a point;
9. N 80° 06' 59" W 98.09 feet, to a point;
10. S 86° 50' 36" W 200.69 feet, to a point;
11. N 76° 01' 00" W 600.00 feet, to a point;
12. N 87° 19' 35" W 101.98 feet, to a point;
13. N 76° 01' 00" W 300.00 feet, to a point;
14. N 66° 05' 25" W 203.04 feet, to a point;
15. N 76° 01' 00" W 400.00 feet, to a point;
16. N 80° 48' 09" W 419.50 feet, to a point;
17. N 76° 01' 00" W 721.83 feet, to a point;
18. N 61° 18' 04" W 58.00 feet, to a point;
19. N 77° 34' 57" W 209.99 feet, to a point;
20. N 87° 19' 18" W 105.00 feet, to a point;
21. N 80° 59' 54" W 283.97 feet, to a point;
22. N 60° 52' 54" W 100.44 feet, to a point;
23. N 53° 24' 23" W 198.00 feet, to a point;
24. N 82° 38' 32" W 233.00 feet, to a point;
25. S 07° 21' 28" W 94.00 feet, to a point;
26. N 89° 54' 32" W 137.00 feet, to a point;
27. N 81° 07' 32" W 128.50 feet, to a point;
28. N 79° 25' 32" W 220.00 feet, to a point;
29. N 30° 52' 32" W 64.00 feet, to a point;
30. N 75° 36' 07" W 154.51 feet, to a point, at the intersection of the West right-of-way line of Fort Worth Drive;

THENCE along the West right-of-way line of said Fort Worth Drive, as follows:

1. N 24° 18' 25" E 70.00 feet, to a point;



2. N 25° 17' 35" E 491.30 feet, to a point;
3. N 29° 59' 55" E 83.50 feet, to a point;
4. N 03° 32' 40" W 74.79 feet, to a point;
5. N 59° 19' 12" E 34.89 feet, to a point;
6. N 30° 02' 17" E 60.77 feet, to a point;
7. N 26° 57' 39" E 100.17 feet, to a point;
8. N 26° 32' 14" E 30.05 feet, to a point;
9. N 25° 32' 15" E 333.90 feet, to a point;
10. N 24° 54' 37" E 424.46 feet, to a point;
11. N 22° 57' 59" E 185.00 feet, to a point;
12. N 21° 36' 20" E 149.49 feet, to a point;
13. N 17° 32' 32" E 332.74 feet, to a point;
14. N 21° 48' 33" E 158.28 feet, to a point;
15. N 00° 49' 33" E 202.70 feet, to a point, at the intersection of the South right-of-way line of W. Collins Street;
16. N 76° 09' 50" W 86.13 feet, along the South right-of-way line of W. Collins Street, to a point;
17. THENCE N 12° 24' 29" E 71.95 feet, crossing said W. Collins Street, to a point, in the North right-of-way line of said W. Collins Street, at the intersection of the West right-of-way line of N. Carroll Boulevard;

THENCE along the West right-of-way line of said N. Carroll Boulevard, as follows:

1. N 00° 27' 34" W 165.43 feet, to a point;
2. N 24° 26' 12" W 198.49 feet, to a point;
3. NORTHWESTERLY 603.92' feet, along said curve to the right, having a radius of 1487.74' feet, a central angle of 23°15'30", and a chord bearing of N 12° 51' 00" W 599.78' feet, to a point at the end of said curve;
4. N 00° 10' 13" W 82.18 feet, to a point;
5. NORTHWESTERLY 468.41' feet, along said curve to the left, having a radius of 1770.96' feet, a central angle of 15°09'16", and a chord bearing of N 10° 44' 14" W 467.05' feet, to a point at the end of said curve;
6. NORTHWESTERLY with a reverse curve 662.29' feet, along said curve to the right, having a radius of 2083.84' feet, a central angle of 18°12'35", and a chord bearing of N 09° 20' 37" W 659.51' feet, to a point at the end of said curve;
7. N 00° 04' 55" W 1662.91 feet, to a point;
8. N 89° 44' 15" E 7.95 feet, to a point;
9. N 00° 07' 25" E 150.00 feet, to a point;
10. S 89° 40' 55" W 4.50 feet, to a point;
11. N 00° 07' 25" E 57.92 feet, to a point;
12. N 02° 52' 47" W 110.15 feet, to a point;
13. N 17° 37' 47" W 62.85 feet, to a point;
14. N 00° 32' 40" W 108.10 feet, to a point;
15. N 89° 48' 18" E 8.00 feet, to a point;
16. N 00° 13' 34" W 1224.08 feet, to a point;
17. N 00° 31' 31" E 614.79 feet, to a point;
18. N 89° 36' 32" W 2.50 feet, to a point;
19. N 00° 25' 28" E 90.34 feet, to a point;
20. N 03° 14' 20" E 50.31 feet, to a point;
21. N 00° 37' 12" E 1421.36 feet, to a point;
22. N 05° 28' 43" E 60.22 feet, to a point;
23. N 00° 18' 27" W 320.34 feet, to a point;
24. N 00° 37' 13" E 541.09 feet, to a point;

THENCE S 89° 25' 00" E 303.22 feet, crossing said N. Carroll Boulevard and running along the North boundary line of the tract of land conveyed to Bobby Lee Lindsey & Clarence Houston Lindsey, by the deed recorded in Volume 5123, Page 3385, of the Deed Records of Denton County, Texas, to a point, at the Northwest corner of said Lindsey Tract, lying in the West right-of-way line of Anna Street;

THENCE S 78° 46' 24" E 50.56 feet, crossing said Anna Street, to a point, at the Northwest corner of the tract of land conveyed to Howard Dewayne Taylor and Shirley Taylor, by the deed recorded in Volume 4356, Page 2576, of the Deed Records of Tarrant County, Texas;

THENCE S 89° 25' 00" E 326.30 feet, along the North boundary line of said Taylor Tract and also the North boundary line of the tract of land conveyed to Sarah L. Fisher, by the deed recorded in County Clerk's File No. 2013-80645, of the Official Records of Denton County, Texas, to a point, at the Northeast corner of said Fisher Tract, lying in the West right-of-way line of Bolivar Street;

THENCE N 55° 28' 31" E 52.56 feet, crossing said Bolivar Street, to a point, at the intersection of the East right-of-way line of said Bolivar Street and the North right-of-way line of W. College Street, also lying at the Southwest corner of the tract of land conveyed to Linda T. King, by the deed recorded in County Clerk's File No. 93-R0070075, of the Official Records of Denton County, Texas;

THENCE S 89° 59' 14" E 805.20 feet, along the North right-of-way line of said W. College Street, to a point in the East right-of-way line of N. Locust Street;

THENCE along the East right-of-way line of said W. Locust Street, as follows:

1. S 00° 19' 17" W 377.41 feet, to a point;
2. S 00° 04' 52" E 1388.58 feet, to a point;
3. S 00° 06' 11" W 489.95 feet, to a point, at the intersection of the North right-of-way line of Hann Street;
4. N 89° 45' 35" E 703.87 feet, along the North right-of-way line of said Hann Street, to a point, in the East right-of-way line of Oakland Street;
5. S 00° 20' 22" E 155.83 feet, along the East right-of-way line of said Oakland Street, to a point, at the intersection of the North right-of-way line of Withers Street;
6. N 89° 38' 22" E 815.80 feet, along the North right-of-way line of said Withers Street, to a point, at the intersection of the East right-of-way line of N. Bell Avenue;

THENCE along the East right-of-way line of said N. Bell Avenue, as follows:

1. S 00° 38' 43" E 550.36 feet, to a point;
2. S 00° 23' 40" E 555.49 feet, to a point, at the intersection of the Southeast right-of-way line of Mingo Road;

THENCE along the Southeast right-of-way line of said Mingo Road, as follows:

1. S 35° 07' 06" W 294.43 feet, to a point;
2. SOUTHWESTERLY 276.73' feet, along said curve to the left, having a radius of 448.00' feet, a central angle of 35°23'30", and a chord bearing of S 17° 25' 21" W 272.35' feet, to a point at the end of said curve;
3. S 00° 16' 13" E 90.47 feet, to a point;
4. S 32° 37' 15" E 11.85 feet, to a point, at the intersection of the North right-of-way line of E. McKinney Street;

THENCE along the North right-of-way line of said E. McKinney Street, as follows:

1. S 87° 45' 48" E 533.29 feet, to a point;
2. SOUTHEASTERLY 84.78' feet, along said curve to the right, having a radius of 471.25' feet, a central angle of 10°18'26", and a chord bearing of S 82° 36' 38" E 84.66' feet, to a point at the end of said curve;

3. SOUTHEASTERLY with a reverse curve 152.60' feet, along said curve to the left, having a radius of 826.08' feet, a central angle of 10°35'03", and a chord bearing of S 82° 46' 34" E 152.38' feet, to a point at the end of said curve;
  4. S 88° 04' 05" E 1164.71 feet, to a point;
  5. S 88° 48' 23" E 594.14 feet, to a point;
- THENCE S 00° 36' 43" W 809.64 feet, crossing said E. McKinney Street and running along the East right-of-way line of S. Crawford Street, as follows:
1. S 89° 58' 19" E 126.35 feet, to a point;
  2. S 01° 14' 21" W 349.99 feet, to a point, at the intersection of the South right-of-way line of E. Mulberry Street;
- THENCE N 87° 12' 23" W 72.55 feet, along the South right-of-way line of said E. Mulberry Street, to a point, at the intersection of the East right-of-way line of aforesaid S. Crawford Street;
- THENCE S 00° 06' 57" W 237.62 feet, along the East right-of-way line of said S. Crawford Street, to a point;
- THENCE S 89° 58' 36" W 500.39 feet, crossing said S. Crawford Street and running along the East right-of-way line of E. Sycamore Street, to a point, at the intersection of the East right-of-way line of S. Bradshaw Street;
- THENCE S 00° 01' 46" W 678.11 feet, along the East right-of-way line of said S. Bradshaw Street, to a point;
- THENCE crossing said S. Bradshaw Street, and running along the South right-of-way line of E. Prairie Street, as follows:
1. N 89° 53' 46" W 1493.46 feet, to a point;
  2. N 88° 28' 04" W 98.97 feet, to a point;
  3. N 89° 50' 37" W 1096.47 feet, to a point, at the intersection of the East right-of-way line of S. Bell Avenue;
- THENCE along the East right-of-way line of said S. Bell Avenue, as follows:
1. S 00° 05' 19" W 610.75 feet, to a point;
  2. SOUTHWESTERLY 207.16' feet, along said curve to the right, having a radius of 433.89' feet, a central angle of 27°21'22", and a chord bearing of S 13° 47' 28" W 205.20' feet, to a point at the end of said curve;
  3. S 27° 29' 32" W 795.31 feet, to a point;
  4. SOUTHEASTERLY 234.14' feet, along said curve to the left, having a radius of 236.01' feet, a central angle of 56°50'39", and a chord bearing of S 00° 55' 47" E 224.66' feet, to a point at the end of said curve, and the intersection of the Northeast right-of-way line of Dallas Drive;

THENCE along the Northeast right-of-way line of said Dallas Drive, as follows:

1. S 45° 00' 34" E 106.97 feet, to a point;
2. S 46° 32' 20" E 261.86 feet, to a point;
3. S 43° 58' 02" E 1431.17 feet, to a point;
4. S 47° 43' 09" E 1474.25 feet, to a point;
5. S 48° 40' 29" E 321.88 feet, to a point;
6. S 47° 09' 02" E 246.52 feet, to a point;
7. S 47° 50' 33" E 2578.02 feet, to a point;
8. S 47° 50' 33" E 218.83 feet, to a point;

THENCE S 55° 30' 11" W 168.77 feet, crossing said Dallas Drive, to the POINT OF BEGINNING, containing approximately 889.8 acres of land.

This document was prepared under 22 TAC 663.21, does not reflect the results of an on the ground survey, and is not to be used to convey or establish interests in real property except those rights and interest implied or established by the creation or reconfiguration of the boundary of the political subdivision for which it was prepared.

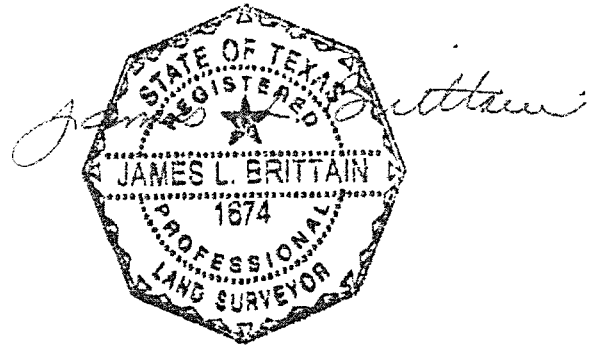

**Exhibit B**  
**Municipal Setting Designation**  
**Affidavit of Eligibility**

BEFORE ME, the undersigned authority, on this day personally appeared Kenneth Banks, as an authorized representative of City of Denton, known to me to be the person whose name is subscribed below who being by me first duly sworn, upon their oath, stated as follows:

I am over the age of 18 and legally competent to make this affidavit. I have personal knowledge of the facts stated herein.

I affirmatively state that (place an X in all applicable blanks)

- The MSD eligibility criteria of THSC Section 361.803 are satisfied.
- True and accurate copies of all documents demonstrating that the MSD eligibility criteria provided by THSC 361.803 have been satisfied and are included with the application.
- A true and accurate copy of a legal description of the proposed MSD property is included with the application.
- Notice has been provided in accordance with THSC 361.805.
- A copy of an ordinance or restrictive covenant and any required resolutions are provided in this application or will be provided before the executive director certifies this application.

Kenneth Banks  
Signature

Date: April 22, 2015

Kenneth Banks  
Printed Name

Director of Environmental Services and Sustainability  
Title

STATE OF TEXAS  
COUNTY OF DENTON

SUBSCRIBED AND SWORN before me on this the 22 day of APRIL 2015, to which witness my hand and seal of office.

Jane E. Richardson  
Notary Public in and for the State of TEXAS

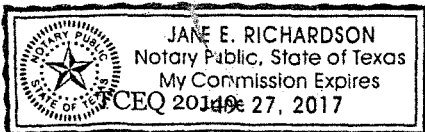

**BRITAIN & CRAWFORD**  
 LAND SURVEYING &  
 TOPOGRAPHIC MAPPING  
 (817) 926-0311 • METRO (817) 429-5112  
 FAX: (817) 926-9387  
 P.O. BOX 11374 • 3908 SOUTH FREEMAN  
 FORT WORTH, TEXAS 76110  
 EMAIL: [info@britain-crawford.com](mailto:info@britain-crawford.com)  
[www.britain-crawford.com](http://www.britain-crawford.com)

SURVEYOR:  
 BRITAIN & CRAWFORD, L.L.C.  
 3908 SOUTH FREEMAN  
 FORT WORTH, TEXAS 76110  
 TEL: 817 926 0311  
<http://www.britain-crawford.com>

1	
2	
3	4

INDEX PAGE

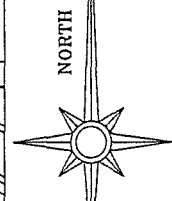
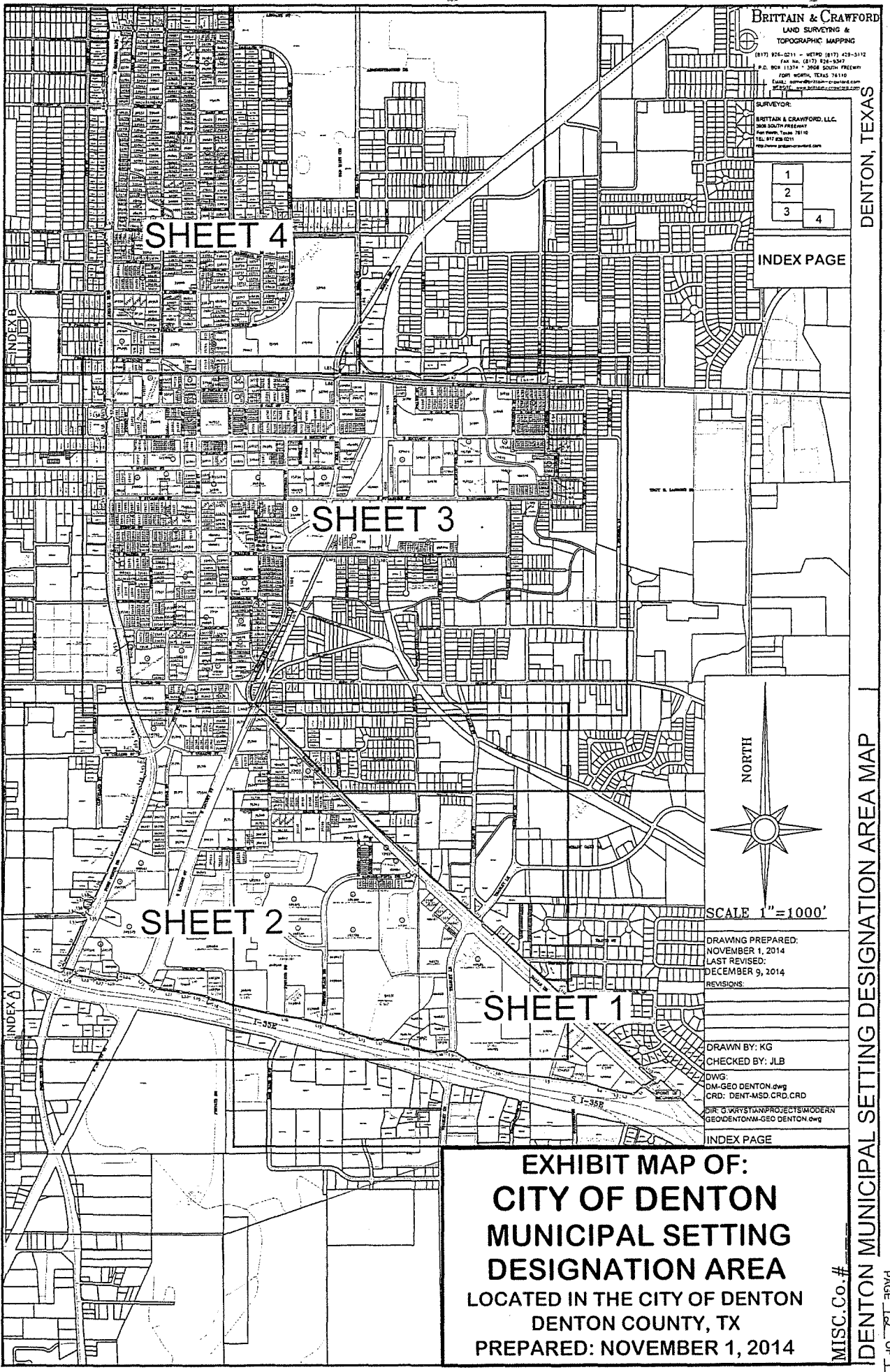

SCALE 1" = 1000'

DRAWING PREPARED:  
 NOVEMBER 1, 2014  
 LAST REVISED:  
 DECEMBER 9, 2014  
 REVISIONS:

DRAWN BY: KG  
 CHECKED BY: JLB  
 DWG:  
 DM-GEO DENTON.dwg  
 CRD: DENT-MSD.CRD.CRD  
 DPK: G.KRYSYANPROJECTS\MODERN  
 GEOIDENTONM-GEO DENTON.dwg

INDEX PAGE

**EXHIBIT MAP OF:  
 CITY OF DENTON  
 MUNICIPAL SETTING  
 DESIGNATION AREA**  
 LOCATED IN THE CITY OF DENTON  
 DENTON COUNTY, TX  
 PREPARED: NOVEMBER 1, 2014

MISC. Co. #

DENTON MUNICIPAL SETTING DESIGNATION AREA MAP

**BRITTAH & CRAWFORD**  
LAND SURVEYING &  
TOPOGRAPHIC MAPPING  
(817) 424-0211 • (817) 424-5112  
Fax No. (817) 424-3147  
P.O. BOX 11321 • 3008 SOUTH FREEMAN  
FORT WORTH, TEXAS 76110  
EMAIL: admin@brittan-crawford.com  
WWW.BRITTAH-CRAWFORD.COM

SURVEYOR  
BRITTAH & CRAWFORD, LLC.  
STATE LICENSE NO. 10517  
10/15/09 TO 08/31/14  
www.brittan-crawford.com

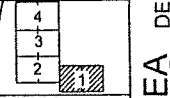

SHEET 1

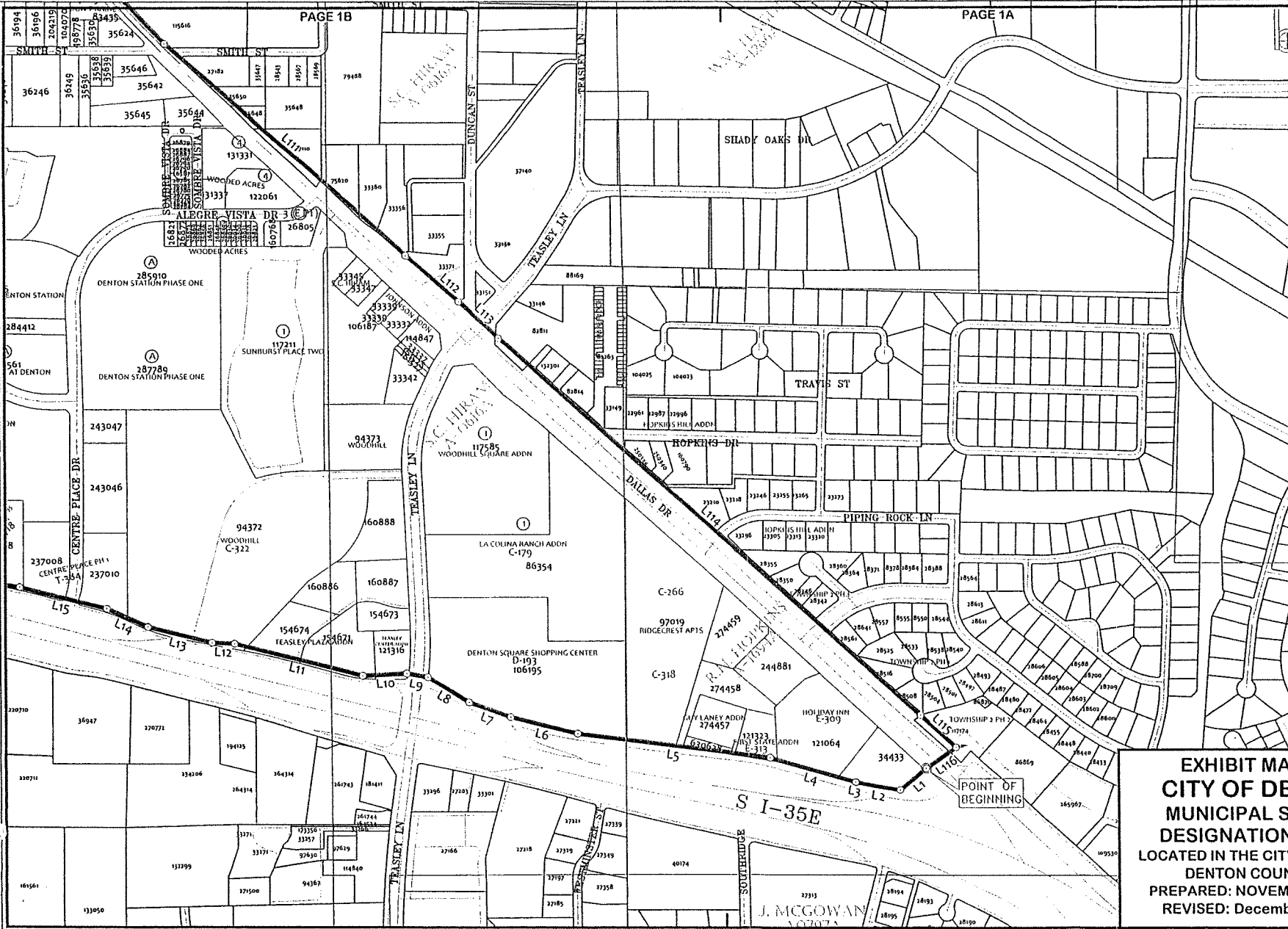
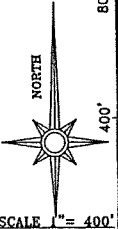
NORTH  
SCALE 1" = 400'

DRAWING PREPARED:  
NOVEMBER 7, 2014  
LAST REVISED:  
REVISIONS

DRAWN BY: KG  
CHECKED BY: JLB  
DWG  
M-550 DENTON Ave  
CITY OF DENTON  
FOR DENTON PROJECT UNDER  
CONSTRUCTION

**EXHIBIT MAP OF:  
CITY OF DENTON  
MUNICIPAL SETTING  
DESIGNATION AREAS  
LOCATED IN THE CITY OF DENTON  
DENTON COUNTY, TX  
PREPARED: NOVEMBER 2, 2014  
REVISED: December 9, 2014**

CITY OF DENTON MUNICIPAL SETTING DESIGNATION AREA DENTON TX  
MISC. Co. #





**BRITTAIN & CRAWFORD**  
 LAND SURVEYING &  
 TOPOGRAPHIC MAPPING

BRITTAIN & CRAWFORD, L.L.C.  
 3008 SOUTH FREWAY  
 FORT WORTH, TEXAS 76116  
 TEL: 817.338.2111  
 WWW.BRITTAINCRAWFORD.COM

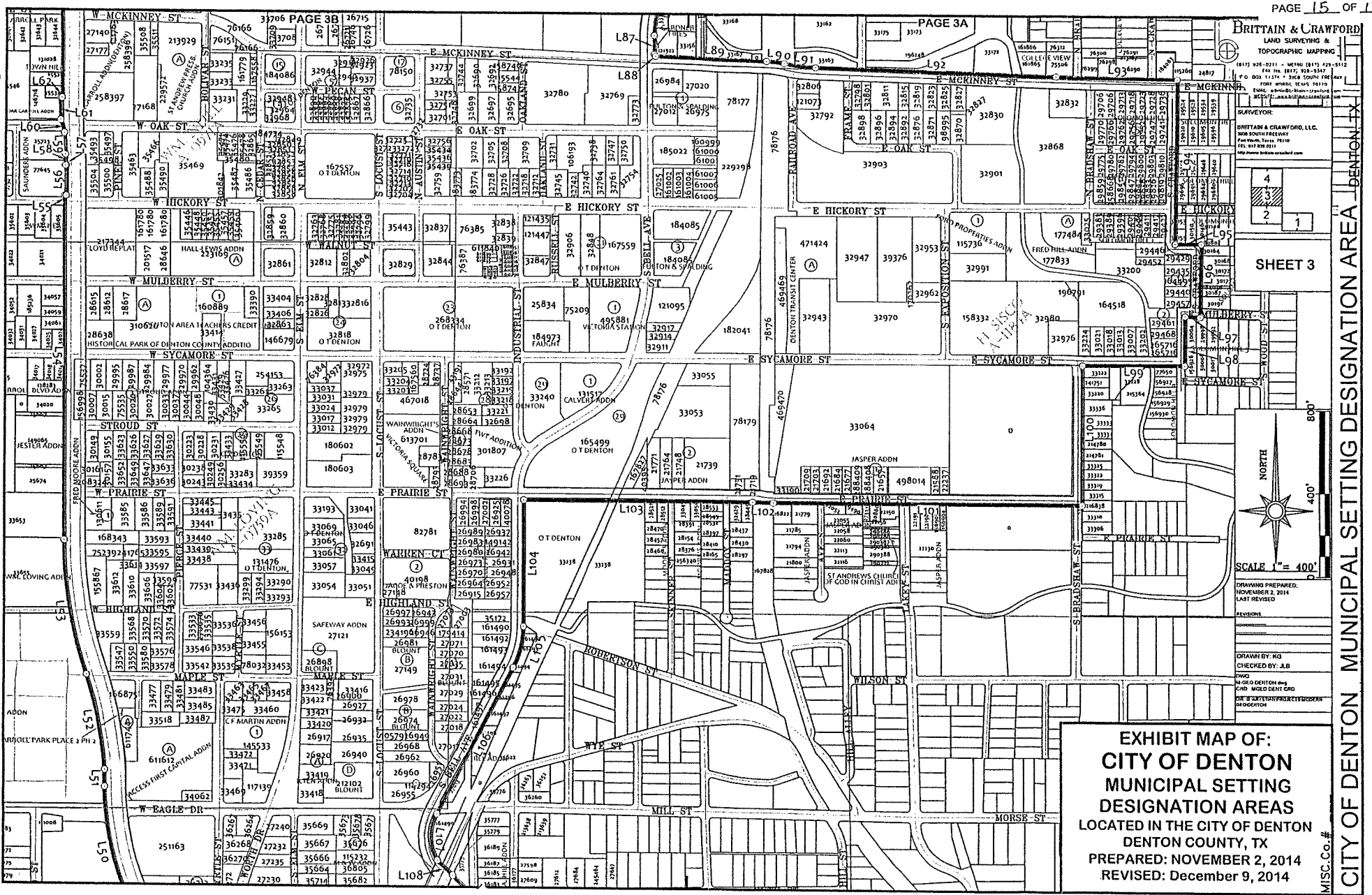

**EXHIBIT MAP OF:  
 CITY OF DENTON  
 MUNICIPAL SETTING  
 DESIGNATION AREAS  
 LOCATED IN THE CITY OF DENTON  
 DENTON COUNTY, TX  
 PREPARED: NOVEMBER 2, 2014  
 REVISED: December 9, 2014**

CITY OF DENTON MUNICIPAL SETTING DESIGNATION AREA - DENTON, TX

4  
2  
1

SHEET 3

NORTH  
 SCALE 1" = 400'

DRAWING PREPARED:  
 NOVEMBER 2, 2014  
 LAST REVISED:  
 REVISIONS

DRAWN BY: KG  
 CHECKED BY: JLB

©2014  
 M-020 DENTON AND  
 C-010 M-020 DENTON AND  
 D-010 C-010 DENTON AND  
 E-010 DENTON AND  
 F-010 DENTON AND

MSC.Co.#

**BRITAIN & CRAWFORD**  
 LAND SURVEYING &  
 TOPOGRAPHIC MAPPING

(817) 948-0111 • FAX (817) 425-5112  
 P.O. BOX 11374 • 3608 South Fwy  
 Fort Worth, Texas 76116  
 Email: info@britain-crawford.com  
 Website: www.britain-crawford.com

**SURVEYOR:**  
 BRITAIN & CRAWFORD, LLC  
 3608 SOUTH FORT WORTH  
 FORT WORTH, TEXAS 76116  
 TEL: 817 948-0111  
 Web: www.britain-crawford.com

**SHEET 4**

SCALE 1" = 400'

DRAWING PREPARED:  
 NOVEMBER 2, 2014  
 LAST REVISION:

REVISIONS:

DRAWN BY: WG  
 CHECKED BY: JB  
 DWG NO: 1400-DENTON-04  
 PROJ: 1400-DENTON-04

**EXHIBIT MAP OF:  
 CITY OF DENTON  
 MUNICIPAL SETTING  
 DESIGNATION AREAS  
 LOCATED IN THE CITY OF DENTON  
 DENTON COUNTY, TX  
 PREPARED: NOVEMBER 2, 2014  
 REVISED: December 9, 2014**

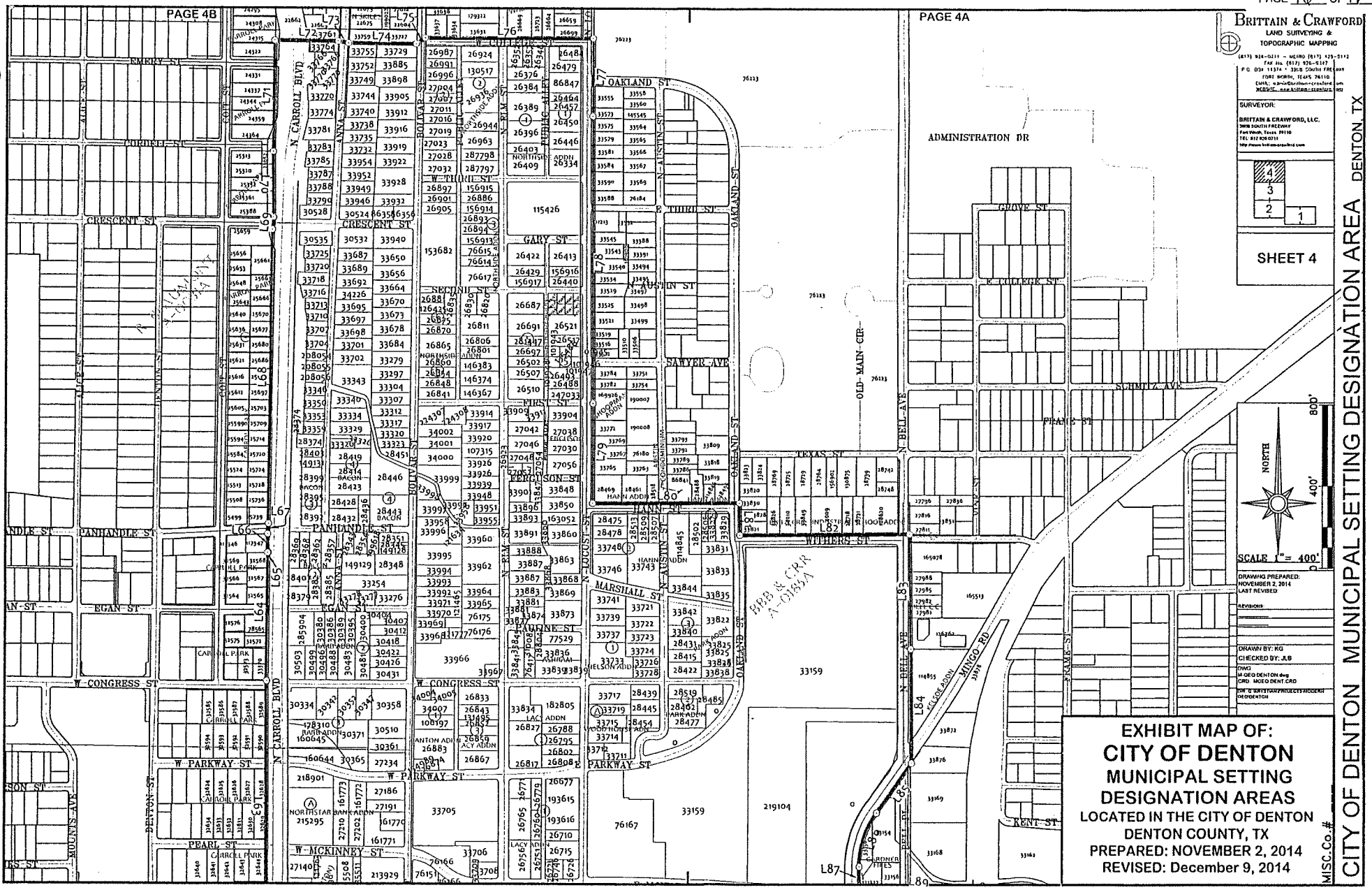

CITY OF DENTON MUNICIPAL SETTING DESIGNATION AREA DENTON, TX  
 MISC. Co. #

